

LCFF State Priorities and Related Data Elements

Pupil Achievement

- » Performance on statewide standardized tests.
- » Score on Academic Performance Index.
- » Share of pupils that meet the requirements for entrance to the University of California and the California State University or complete career technical education sequences or programs.
- » Share of English learners that become English proficient.
- » English learner reclassification rate.
- » Share of pupils that pass Advanced Placement exams with 3 or higher.
- » Share of pupils determined prepared for college by the Early Assessment Program.

Pupil Engagement

- » School attendance rates.
- » Chronic absenteeism rates.
- » Middle school dropout rates.
- » High school dropout rates.
- » High school graduation rates.

Other Pupil Outcomes

- » Other indicators of pupil performance in required areas of study.

School Climate

- » Pupil suspension rates.
- » Pupil expulsion rates.
- » Other local measures.

Parental Involvement

- » Efforts to seek parent input.
- » Promotion of parental participation.

Basic Services

- » Rate of teachers appropriately assigned and fully credentialed.
- » Pupil access to standards-aligned instructional materials.
- » Facilities maintained in good repair.

Implementation of State Standards

- » Implementation of State Board of Education-adopted academic content and performance standards for all pupils, including English learners.

Course Access

- » Pupils access and enrollment in all required areas of study.



LEA Planning Cycle

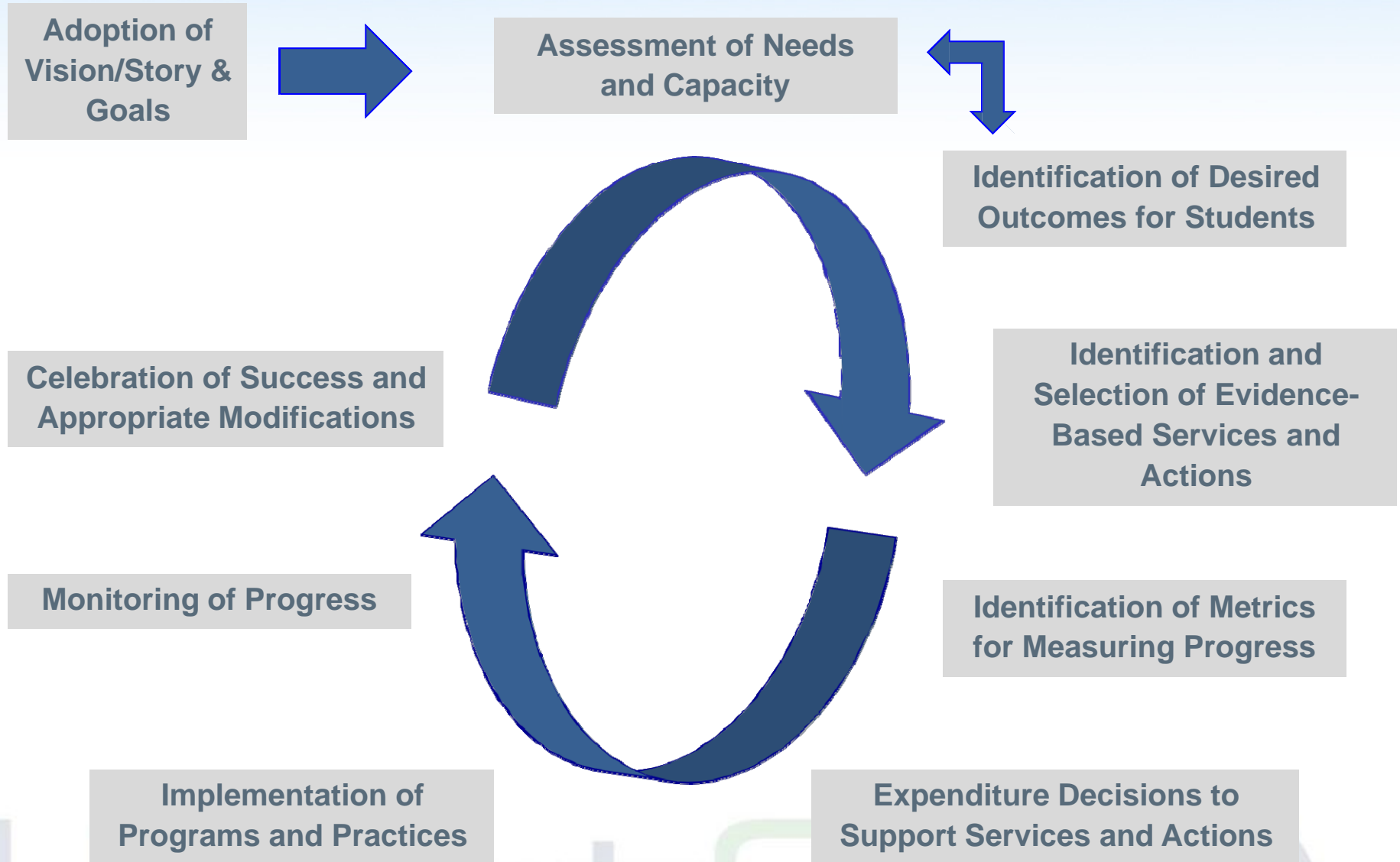

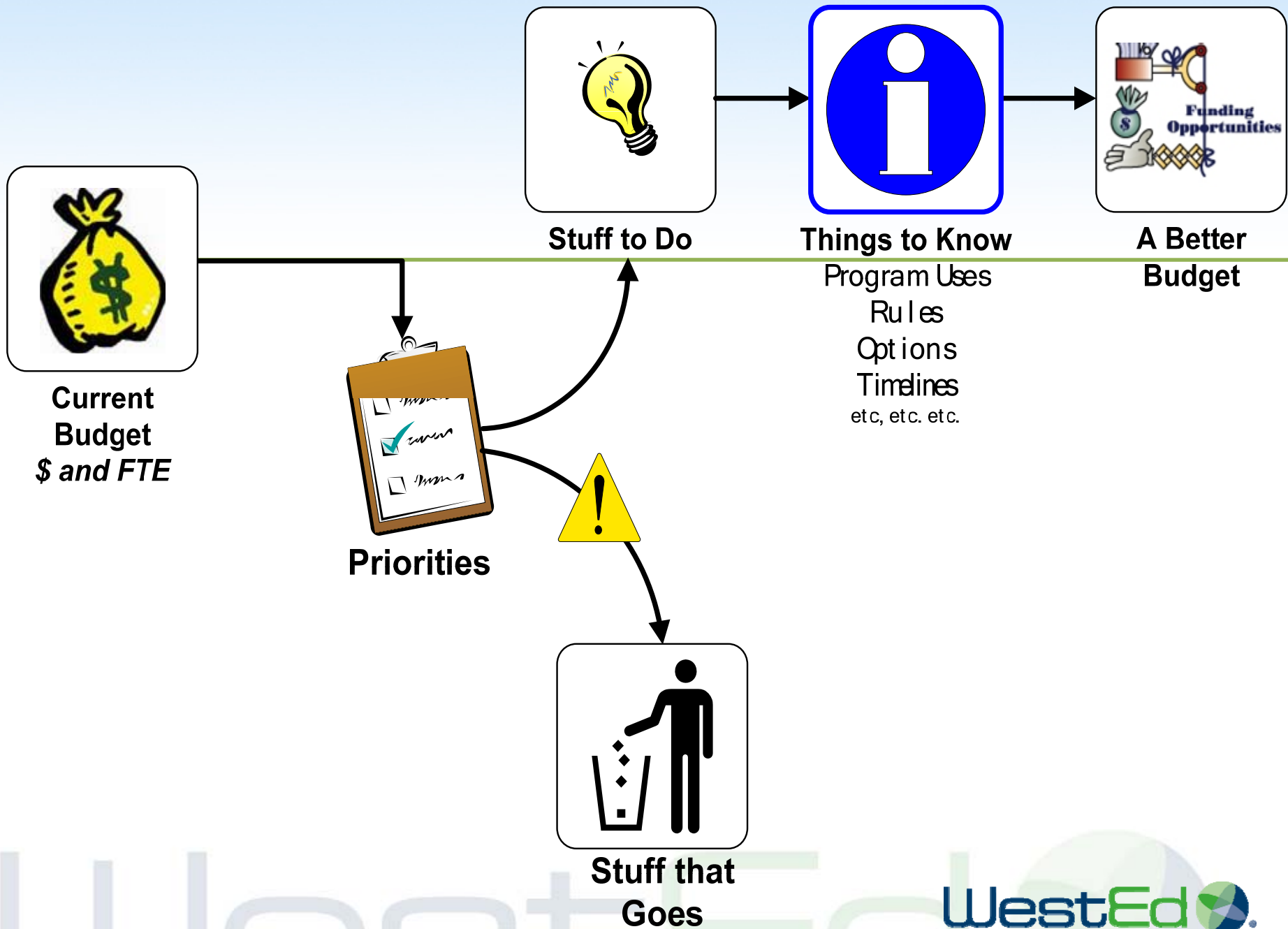

Building a Budget with Complements

